

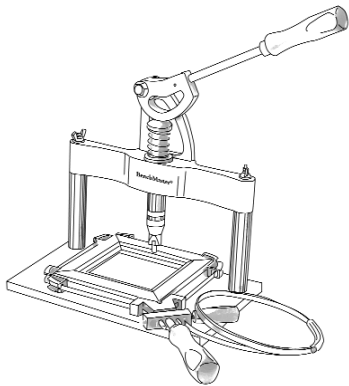

FrameCo BENCHMASTER

#14728 & #14729

PICTURE FRAME JOINER & FITTING TOOL



Assemble your BenchMaster®

Your PushMaster® fits neatly into the BenchMaster® cross beam, creating a more powerful driving action. Unload your PushMaster® to fit the backing nails or flexipoints into the back of the frame, once you have completed joining.

Instructions

1. It is important that the corners of the frame you intend to join be held firmly together before V-Nailing. The pressure of the V-Nail entering the base of the moulding can force the joint to open if the frame is not held securely. The FrameCo Steel Strap Clamp was especially made for picture frame clamping and is ideal to use with the BenchMaster®. Glue on all joints is also recommended.
2. Select a V-Nail suitable to the moulding height. As a general rule, use a V-Nail about 50-60% of the moulding height. V-Nails are available in 5 different lengths and the BenchMaster® will take all sizes. Included with the kit are 7mm (1/4"), 7mm Hardwood and 10mm (3/8") V-Nails - these are the most useful sizes.

When you peel off one V-Nail from the cartridge, the sharp edge, or top, is facing down. This is the end which enters the wood first.

3. The V-Nail is positioned AROUND the magnetic tip of the PushMaster®. Make sure the V-Nail is sharp edge down. Align the V-Nail across the mitre, so that the sides of the V-Nail are parallel with the frame sides. This will also be with the grain in the timber.

On top of each V-Nail is a small amount of silicone tape which acts as a lubricant and assists the V-Nail to penetrate the wood more easily. It is therefore important to use only V-Nails with a silicone top, as well as those which have a very sharp cutting edge and a sharp right angle crease down the middle. All brands of V-Nail are NOT the same, so for best results use only genuine FrameCo V-Nails.

4. For wide moulding V-Nail in two positions, i.e. front and back. Insert the front V-Nail first (i.e. near the rebate), then the second close to the centre of the moulding. Do not place a V-Nail in the back 1/3 of the joint. More "holding power" is obtained from V-Nails placed near the rebate. Usually only two V-Nails are necessary.

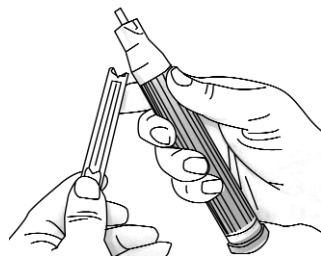
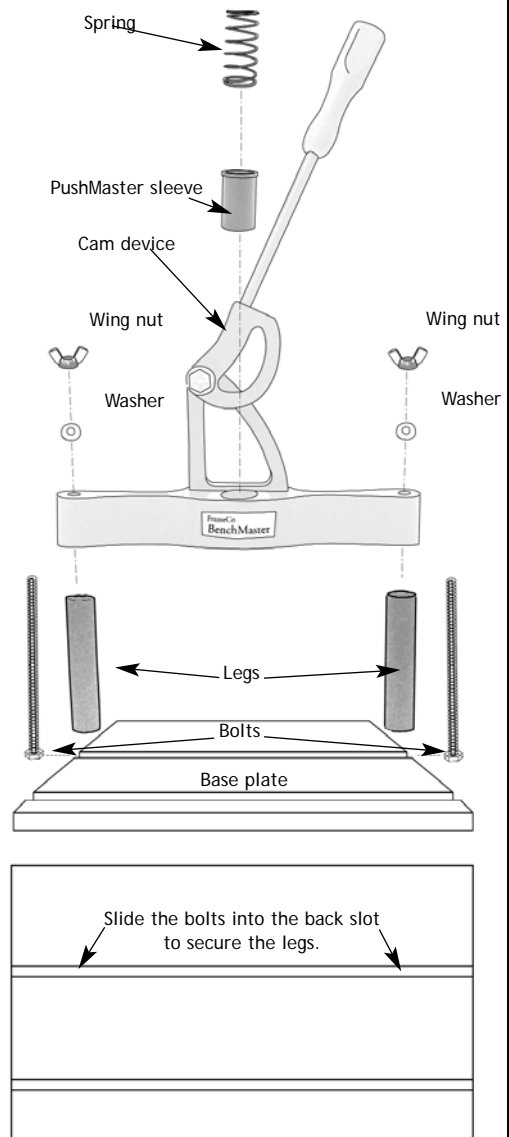

Push the slide firmly upwards, then release. Too much pressure will cause 2 V-Nails to be loaded

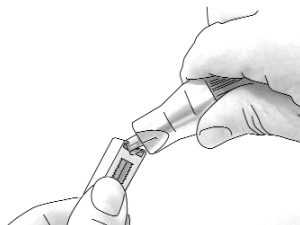

Insert the PushMaster® into the end of the cartridge UNDER the exposed V-Nails. Pull the PushMaster® outwards to prior off ONE V-Nail onto the Magnetic Tip



Use your thumb for extra leverage to remove the nail

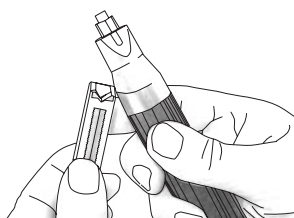

check that only one V-Nail has been loaded

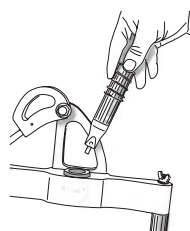

Insert PushMaster® into the BenchMaster®

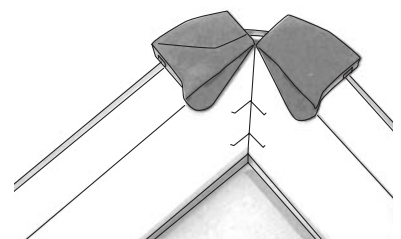
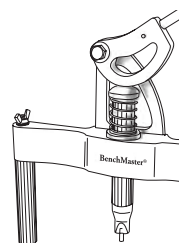

Make sure the V-Nails are parallel with the side of the frame

perfect joins everytime



FrameCo - Australia
 20 Joseph Street
 Blackburn North VIC 3130
 Freecall: 1800 033 619
 Email: frame@frameco.com.au

FrameCo - U.K.
 Unit 1 East41 Garside Way, Stocklake
 Aylesbury, Bucks UK HP20 1BH
 Freecall: 0800 389 0767
 Email: info@clubframeco.co.uk

FrameCo - U.S.A.
 3850 Ramada Drive D-1
 California USA 93446
 Freecall: 800 682 1222
 Email: info@frameco-usa.com

5. With some moulding, the front or rear may need support, if the frame does not rest flat on the table. Use cardboard pieces or the "Corner Jack" to support the underside of the moulding. The frame should not move while the V-Nail is being inserted. A good quality clamp to hold the frame firmly is essential to obtain a good joint. See Step 1.
6. V-Nails are made in two different grades - Normal (white top) and Hardwood (red top). The hardwood V-Nails are used for very hard, close-grained timbers and should not be used in soft, pine-type moulding. Cartridges with white top contain normal V-Nails; cartridges with a red top contain hardwood V-Nails. It is suggested to try normal V-Nails first in most timbers and reserve the hardwood V-Nails for difficult to join moulding only.
7. PushMaster® inserts flexipoints and backing nails. Use the groove or slots in the head of the PushMaster® for this purpose. The side of the frame needs to be firmly supported with the Frame Stop when inserting backing points. If the flexipoints bend or the timber is very hard, hit the PushMaster® with a mallet.

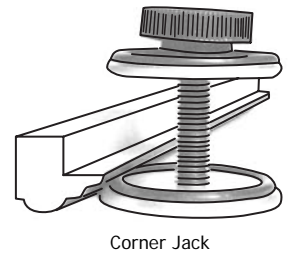

Corner Jack

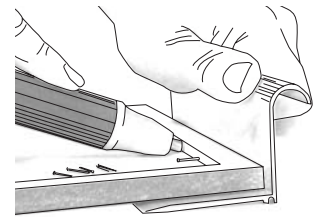

PushMaster® inserts nails and flexipoints

BenchMaster® Options

1. LEG EXTENSION KIT

Optional kit to extend the height of the cross beam. Joins moulding up to 120mm (5") high.

2. HANGER & HINGE KITS

Optional kits to fit frame hangers and frame stand backs.

3. IMPROVE STABILITY

To improve the stability of the BenchMaster, secure the base plate to the bench with 2 G-clamps. This is especially useful when joining hard moulding or using the hanger and/or hinge heads.

4. BENCH MOUNTING OPTION

For a more permanent set up and added driving power, remove the base plate and mount the BenchMaster® directly onto the bench. Drill two 4mm (3/16") holes through the bench to take the leg bolts. Countersink the holes to avoid loss in joining height.

5. OPTIONAL BASE PLATE CLAMP

The base plate clamp holds the frame corner firmly when joining. This clamp will be most useful for complex-shaped mouldings, compound mitres and hard timbers. Combined with the Corner Jack, it will prevent any movement or opening of the frame corner when V-Nailing.

MAINTENANCE

Because the head of your PushMaster® contains a magnet, it will attract foreign particles. Periodically remove the magnet and spring to clean out the hole and also wipe the magnet and spring with a clean, dry cloth.

Please note: Only a sample quantity of backing nails, flexipoints & screw eyes are included with each kit. Replacement packs are available.

#14728 BenchMaster I Joiner - joiner only

#14729 BenchMaster II Joiner - complete with PushMaster

#14727 BenchMaster Leg Extension Kit

#14726 BenchMaster Beam Offset Kit

#14732 Base Plate Clamp

