

HINGE ARTWORKS

PROJECT: #25255

Difficulty Rating:
 ★ ★ ★ ★ ★

What you will need:

- 1 x Mat Board with pre cut window
- 1 x Fome Core - backing board
- Hinging Tape such as:
 - a) Gummed Linen Tape
 - b) Mounting Tape
 - c) Framers Tape II
- 1 x Trimming Knife



#80011 Fome Core



#17045 Gummed Linen Tape



#17038 Mounting Tape



#17040 Framers Tape II

FrameCo - Australia
 Email: frame@frameco.com.au

FrameCo - Euro / U.K.
 Email: frame.uk@clubframeco.com

FrameCo - U.S.A.
 Email: info.usa@clubframeco.com

Hinging will help keep your artwork crease free and will preserve the artwork for years to come.

Suggested Method

1. First start with the mat, and the correct window opening required for your artwork - see fig. 1.



Workshop Notes #25101

2. Place the newly cut window mat onto a piece of Fome Core board and cut around it to create a backing board the same size as your mat - see fig. 2.

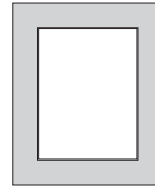

fig.1

Prepare the mat board with the required window for the artwork.

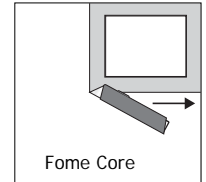

fig.2

Using the mat board as a guide, cut the fome core board using a trimming knife.

3. Place the mat on top of the Fome Core then open it upwards as if you were opening a book, now the mat will be face down and positioned at the top of the Fome Core backing - see fig. 3.

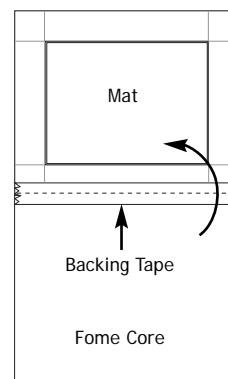

fig.3

Turn the mat board upside down and hinge to the fome core.

4. Using FrameCo Backing Tape make a hinge between the two boards - see fig.3. For valuable artworks the acid free Gummed Linen Tape #17045 is more suited for conservation framing.

Note: This step is optional

5. Once the tape is in place fold back the hinged mat so it is now on top of the fome core backing - place the artwork between the mat and the backing in the position required, ie. Align the artwork carefully so that the mat covers the edges of the artwork.

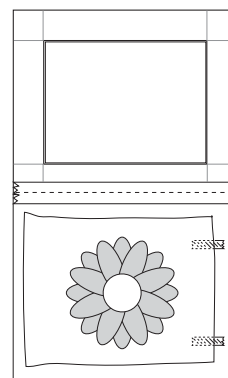
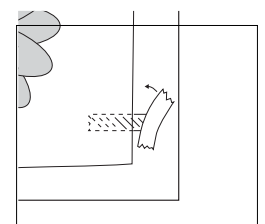

fig.5

Attach mounting tape on the reverse side of the artwork and place into desired position.

6. Open the mat again, be careful not to move the position of the artwork. With a pencil, make several registration marks near the corners on the backing for future alignment - see fig. 4.



Attach another strip of mounting tape over the top of the previously attached tape and fome core - making a T-hinge.

7. Remove the picture and attach 2 pieces of mounting tape (#17038) to the back of the artwork, at the top, about 1/3 in from each side. Replace the picture and align with the registration marks then attach a further piece of mounting tape across the top creating the T-Hinge - see fig. 5.

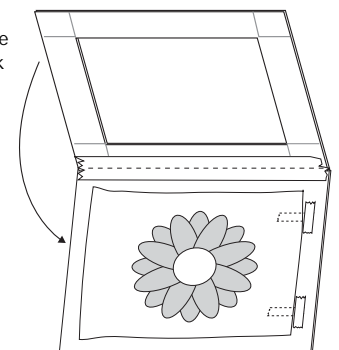

Close the mat board over the artwork - ready for framing.