

CUT A V-GROOVE

PROJECT: #25113

Difficulty Rating:



What you will need:

- 1 x Mat Board with precut window
- 1 x GrooveMaster™ V-Groove Kit
- 1 x Mat Master™ Rule
- 1 x 2H Pencil
- 1 x Document Cleaning Pad



#14400 GrooveMaster™ V-Groove Kit



#17453 Document Cleaning Pad



#14209 Mat Master™ Rule

A V-groove can be located anywhere on the mat face. But as the main function of the V-groove is to guide the viewer's eye into the picture it is best placed on the outer or inner 1/3 of the mat and not in the middle. This is what we have found to be visually more pleasing. Remember that there is no one correct position. We normally recommend to locate the V-groove 1.5cm (1/2") from the bevel edge of the mat.

Instructions

Cut the mat opening first - then cut the V-groove.

1. Use the GrooveMaster Gauge included with the GrooveMaster V-Groove Kit to mark out the start and finish lines. The slots in the gauge are approx. 1cm apart and you can use the top or bottom of each slot/ chevron. Remember to use the same position on each corner. Draw short "light" lines on the front surface of the mat. These are your start and finish positions.
2. Fit the GrooveMaster onto the Mat Master Rule. Position the GrooveMaster over the first set of corner lines. Check that the blades are aligned with the downward line. Ensure that the GrooveMaster is attached to the rule. Use the inspection hole in the front of the GrooveMaster to sight the correct position.
3. Now move the GrooveMaster to the bottom set of lines. Align the blades over the lines and reposition your ruler. Repeat the process making sure the ruler is in the correct position. This process will ensure you cut a straight v-groove. The GrooveMaster will attach to a Mat Master Rule, Logan Adapta-Rule can run alongside any straight edge, or professional mount cutter.
4. Start at the top position, press the blades into the mat with a smooth constant pressure pull the cutter downwards to the finish position. Stop when you see the intersecting line appear in the sight hole. Remove the GrooveMaster carefully so that you do not tear away the waste material.
5. Rotate the mat clockwise ready to cut the next side. Position the GrooveMaster on the next set of corner cross lines and cut down to the first groove. Repeat for the third and fourth side. Use a Document Cleaning Pad to erase any pencil lines.

TIP: Fit a FrameCo Stop (#71017) to your rule or cutter - this will give you a better result when finishing.

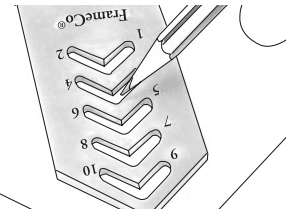

fig. 1.
Use the corner Gauge to mark out the start and finish lines.

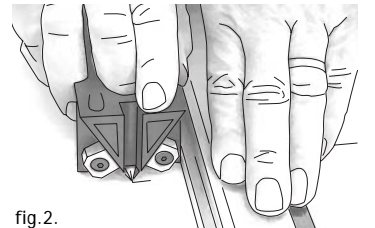

fig. 2.
Place your third finger into the finger grip hole to gain more control when cutting.

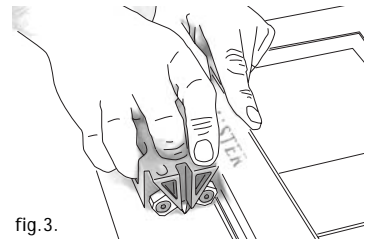

fig. 3.
START
Align blades with vertical line.

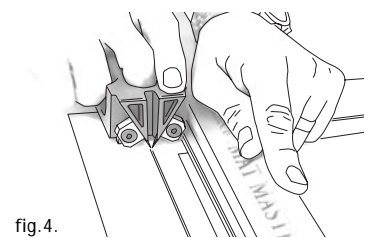

fig. 4.
FINISH
Press in blades & cut a v-groove down to bottom position.

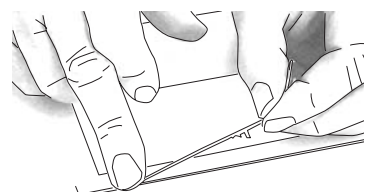

fig. 5.
Do not remove the waste material, place back into the groove, until all grooves are cut.

FrameCo - Australia

Email: frame@frameco.com.au

FrameCo - Euro / U.K.

Email: frame.uk@clubframeco.com

FrameCo - U.S.A.

Email: info.usa@clubframeco.com